

FIG 1:

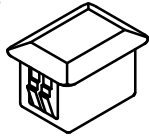

FIG 2:

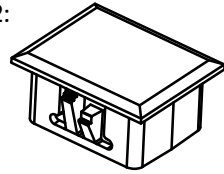
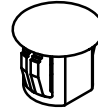

FIG 3:



REV.	MODIFICATION.	DATE	DRN
01	C0-2010730	15/07/09	OW
02	C0-2010780	25/08/09	OW
03	C0-2010881	05/02/10	OW
04	C0-2010984	07/09/10	SF
05	C0-2011040	19/01/11	SF

PART No.	"A"	"B"	"C"	"D"	"E"	"L1"	"L2"	PANEL THICKNESS	FIG	COLOUR
BPE-SC-1-01	21.5 +0.6 -0 [.85 +.024 -0]	12.8 [.50]	12 [.47]	9.3 [.37]	1.5 [.059]	13 [.512]	9.5 [.374]	1.4 - 3.5 [.550 - .138]	1	BLACK
BPE-SC-2-01	16 [.63]									
BPE-SC-3-01	34.8 [1.37]	25.8 [1.02]				26 [1.024]				
BPE-RJ45-01	17.7[.70]	14.7 [.58]	22[.87]	19.1 [.75]		19.3-20 [.760-.787]	14.9-15 [.587- .591]	0.75[.030], 1.2[.050], 1.6[.060], 2.7 [.110], 3.5 [.140]	2	GREY
BPE-LC-D-01	15 [.59]	13.2 [.52]	15 [.59]	13.2 [.52]	2 [.078]	13.5 [.532]	13.5 [.532]	0.75[.030], 1.2[.050], 1.6[.060], 2.7 [.110], 3.75 [.148]	1	BLACK
BPE-ST-1-01	Ø12 [.47]	Ø9.2 [.36]	Ø12 [.47]	7.7 [.30]	1.5 [.059]	Ø9.4 [.370]	7.9 [.311]	1.4 - 3.5 [.055 - .138]	3	

FIG 1:

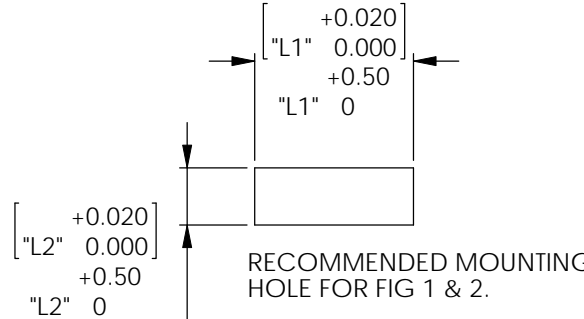
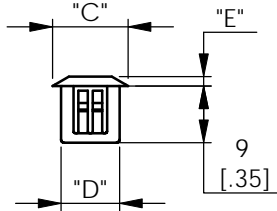
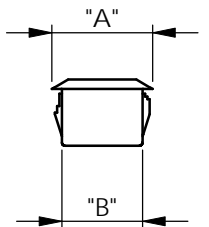

- NOTES:  
 1) ALTERNATE UNITS FOR REFERENCE ONLY  
 2) PARTS AVAILABLE IN OTHER COLOURS BY SPECIAL ORDER  
 3) PARTS AVAILABLE IN NYLON 6/6 UL94 V-0(RMS-19) BY SPECIAL ORDER, REPLACE -01 WITH -19 AT END OF PART NUMBER

FIG 2:

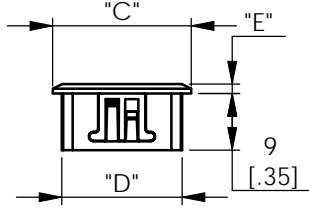
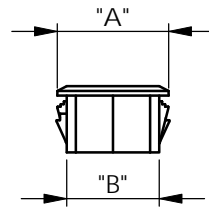
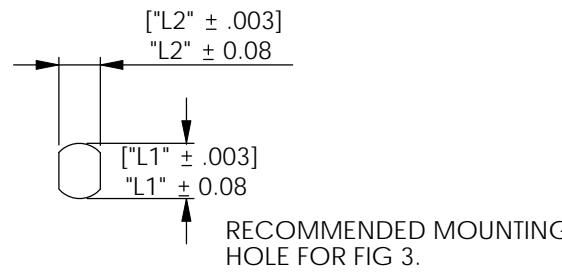
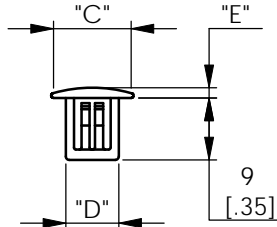
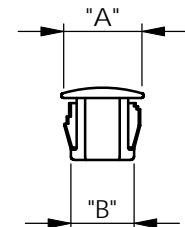

FIG 3:



INFORMATION CONTAINED IN THIS DOCUMENT IS CONFIDENTIAL TO RICHCO INTERNATIONAL Co. Ltd. AND MAY NOT BE DISCLOSED OR REPRODUCED IN WHOLE OR PART WITHOUT THEIR WRITTEN CONSENT.

**RICHCO, INC.**  
 WWW.RICHCO-INC.COM

ALL DIMENSIONS IN mm  
 GENERAL TOLERANCES ±0.25  
 UNLESS OTHERWISE STATED  
 1 DECIMAL PLACE ±  
 2 DECIMAL PLACES ±  
 ANGULAR ±1°

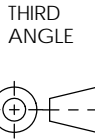

MATERIAL:  
 NYLON 6/6 UL94 V-2 (RMS-01)

COLOUR:  
 SEE TABLE

DESCRIPTION:  
 BLANKING PLUGS

PART No:  
 SEE TABLE

DRG No:  
 09-071

NPR No:  
 N/A

SHEET SIZE  
 A4

DRN  
 OW

DATE  
 15/07/09

CHKD  
 TC

DATE  
 15/07/09

SCALE  
 NTS

SHEET No.  
 1 OF 1